



## RETAIL SPACE NOW AVAILABLE

Lease Rate:	\$28.00 SF/yr (NNN)
Available SF:	1,000 SF
Building Size:	13,500 SF
Year Built:	2015
Market:	North
Cross Streets:	W Memorial Rd & McAuley Rd

04082020

## PROPERTY OVERVIEW

Located in a rapidly growing area of northwest Oklahoma City, Shoppes at McAuley Plaza serves several new high income housing additions, mixed use retail/office complexes, and medical facilities.

McAuley Place sits at the intersection of McAuley and Memorial, with direct access to Kilpatrick Turnpike resulting in a heavy flow of traffic. An average of 29,000 cars pass daily along the Kilpatrick alone. Gaillardia, a private golf community is directly to the west of the center.

Mercy Health Center resides across the highway with approximately 300 beds and a recent addition, the Oklahoma Heart Hospital, specializing in heart health care.

## LOCATION OVERVIEW

OKC was named one of the fastest growing cities in the US by Forbes. Northwest Oklahoma City has a desirable housing market that includes many high-end neighborhoods and country clubs as well as a flourishing multifamily housing market . Over 8,300 apartment units in the Corridor, another 1,000 units proposed or under construction

**GEORGE WILLIAMS, CCIM**  
405.239.1270  
gwilliams@pricedwards.com  
pricedwards.com

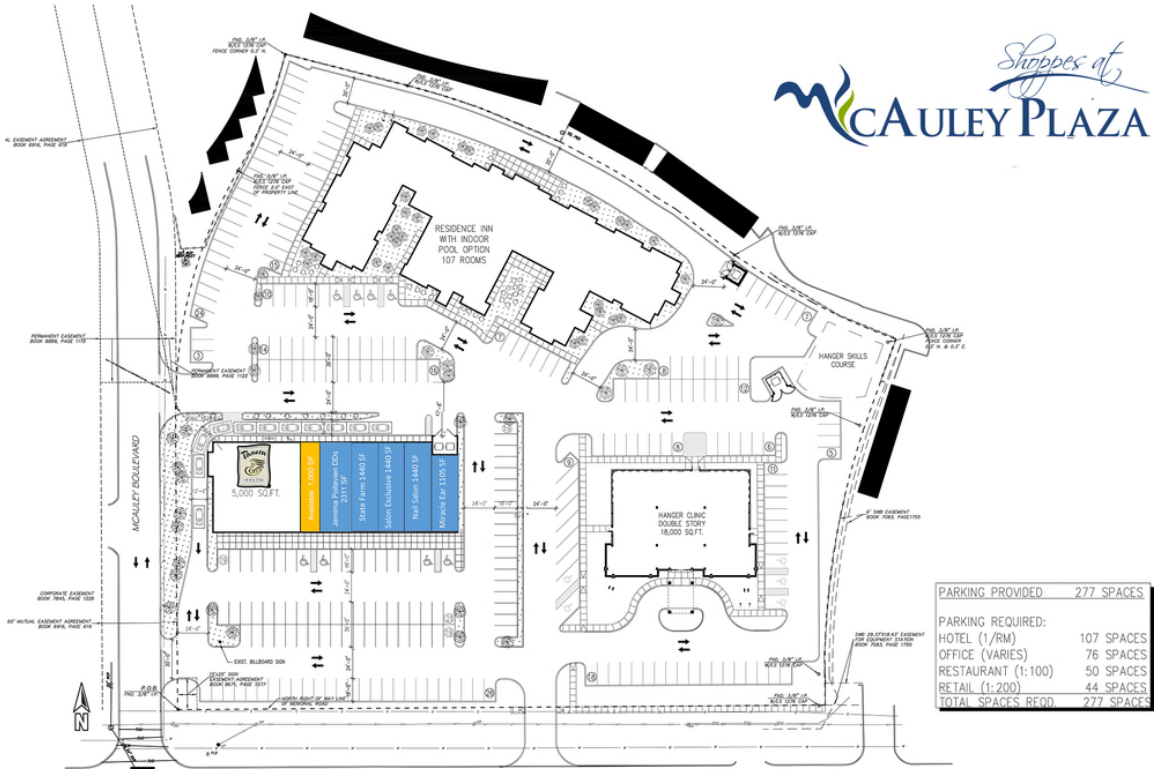

**DEMOGRAPHICS (PER 2010 CENSUS; 5 MILES RADIUS)**

Total Population	454,988
Population Density	454,988
Median Age	35.6
Median Age (Male)	34.3
Median Age (Female)	36.7
Total Households	188,730
# of Persons Per HH	2.4
Average HH Income	\$69,189
Average House Value	\$182,362

**TRAFFIC COUNTS (PER ACOG)**

Memorial Rd	East	22,326
Memorial Rd	West	30,616
John Kilpatrick Turnpike	East	21,357
John Kilpatrick Turnpike	West	27,184

**GEORGE WILLIAMS, CCIM**  
405.239.1270  
gwilliams@pricedwards.com  
pricedwards.com

The information above has been obtained from sources believe reliable. While we do not doubt its accuracy, we have not verified it and make no guarantee, warranty, or representation about it. You and your legal and technical advisors should conduct a careful, independent investigation of the property to determine to your satisfaction to the suitability of the property for your needs.